

4-1 Rectifier Diodes	40
4-1-1 1 Chip	40
4-1-2 2 Chip	41
4-1-3 Bridge	41
4-2 Fast Recovery Rectifier Diodes	42
4-2-1 1 Chip	42
4-2-2 2 Chip	44
4-3 Ultra-Fast Recovery Rectifier Diodes	46
4-3-1 1 Chip	46
4-3-2 2 Chip	48
4-3-3 Bridge	49
4-4 Schottky Barrier Diodes	50
4-4-1 1 Chip	50
4-4-2 2 Chip	52
4-4-3 Bridge	53
4-5 High-Voltage Rectifier Diodes	54
4-6 Damper Diodes	55
4-6-1 Damper Diodes	55
4-6-2 DM Damper Diodes	56
4-7 Avalanche Diodes with Built-in Thyristor	57
4-8 Power Zener Diodes	58
4-9 Silicon Varistors	59

4-1-1 1 Chip

Part No.	V _{RM} (V)	I _F (A)	I _{FSM} (A)	Package	Fig. No.	
EM 1Y	100	1.0	45	Axial(E1)	4	
RM 4Y		3.0	200	Axial(R4)	8	
SFPM-52	200	0.9	30	Surface mount (SFP)	1	
AM01Z			35	Axial(A0)	2	
SFPM-62		1.0	45	Surface mount (SFP)	1	
EM01Z			45	Axial(E0)	3	
EM 1Z			45	Axial(E1)	4	
RM 1Z			50	Axial(R1)	5	
RO 2Z			1.2	80	Axial(R2)	6
RM 2Z				100		
RM 10Z		1.5	120	Axial(R1)	5	
RM 4Z		3.0	200	Axial(R4)	8	
SFPM-54	400	0.9	30	Surface mount (SFP)	1	
AM01			35	Axial(A0)	2	
SFPM-64		1.0	45	Surface mount (SFP)	1	
SFPM-74			50	Axial(E0)	3	
EM01			45			
EM 1			45			
RM 1			50			Axial(R1)
EM 2			1.2	80	Axial(E1)	4
RO 2		80		Axial(R2)	6	
RM 2		100				
RM 10		150		Axial(R1)	5	
RM 3		2.5	150	Axial(R3)	7	
RM 4		3.0	200	Axial(R4)	8	

Part No.	V _{RM} (V)	I _F (A)	I _{FSM} (A)	Package	Fig. No.
AM01A	600	1.0	35	Axial(A0)	2
EM01A			45	Axial(E0)	3
EM 1A			45	Axial(E1)	4
RM 1A			50	Axial(R1)	5
EM 2A		1.2	80	Axial(E1)	4
RO 2A			80	Axial(R2)	6
RM 11A			100	Axial(R1)	5
RM 2A			100	Axial(R2)	6
RM 10A			150	Axial(R1)	5
RM 3A			2.5	150	Axial(R3)
RM 4A	3.0	200	Axial(R4)	8	
RM 4AM	3.2	350			
RM 1B	800	0.8	40	Axial(R1)	5
EM 1B		1.0	35	Axial(E1)	4
EM 2B		80	Axial(E1)		
RO 2B		80	Axial(R2)	6	
RM 11B		1.2	100	Axial(R1)	5
RM 2B			100	Axial(R2)	6
RM 10B			150	Axial(R1)	5
RM 3B		2.5	150	Axial(R3)	7
RM 4B		3.0	150	Axial(R4)	8
RM 1C		1000	0.8	40	Axial(R1)
EM 1C	1.0		35	Axial(E1)	4
RO 2C	1.2		80	Axial(R2)	6
RM 11C			100	Axial(R1)	5
RM 2C			100	Axial(R2)	6
RM 3C			2.0	150	Axial(R3)
RM 4C	3.0		150	Axial(R4)	8

External Dimensions

• No. 1 Surface Mount (SFP)

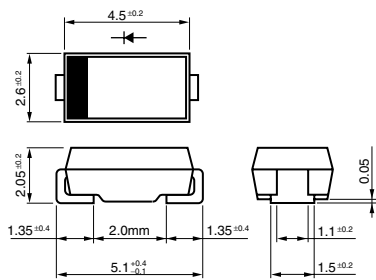

• No. 2 Axial (A0)

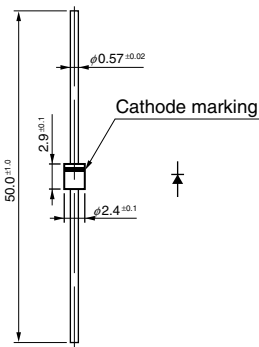

• No. 3 Axial (E0)

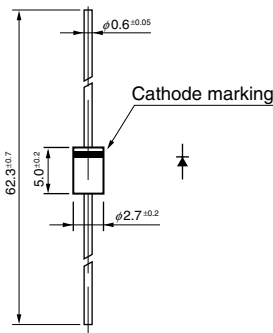

• No. 4 Axial (E1)

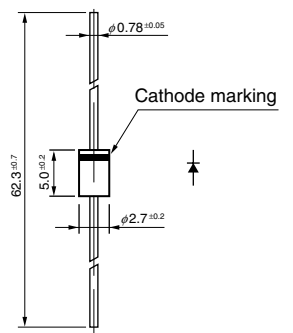

• No. 5 Axial (R1)

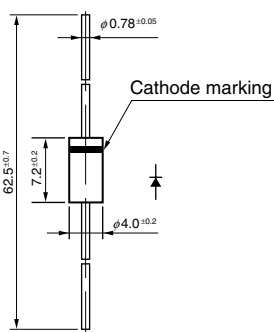

• No. 6 Axial (R2)

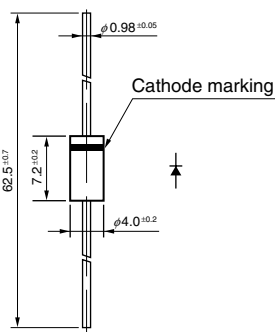

• No. 7 Axial (R3)

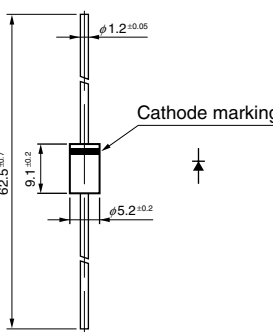

• No. 8 Axial (R4)

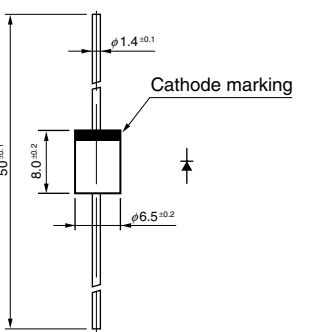

(unit: mm)

4-2-1 1 Chip

trr① : Ir=If

90% Recovery Point

trr② : Ir=2×If

75% Recovery Point

Part No.	V _{RM} (V)	I _F (A)	I _{FSM} (A)	trr① (μS)	trr② (μS)	Package	Fig. No.	
EU 2YX	100	1.2	25	0.2	0.08	Axial(E1)	3	
RU 2YX		1.5	30	0.2	0.08	Axial(R1)	4	
RU 3YX		2.0	50	0.2	0.08	Axial(R2)	5	
RU 4Y		3.5	70	0.4	0.18	Axial(R4)	7	
RU 30Y			100	0.4	0.18	Axial(R3)	6	
RU 4YX		4.0	100	0.4	0.18	Axial(R4)	7	
FMU-G2YXS		10.0	100	0.2	0.08	TO-220F-2Pin	8	
EU01Z	200	0.25	15	0.4	0.18	Axial(E0)	2	
EU 1Z			15	0.4	0.18	Axial(E1)	3	
AU01Z		0.5	15	0.4	0.18	Axial(A0)	1	
RF 1Z		0.6	15	0.4	0.18	Axial(R1)	4	
AS01Z			20	1.5	0.6	Axial(A0)	1	
EH 1Z			30	4.0	1.3	Axial(E1)	3	
RH 1Z		35	4.0	1.3	Axial(R1)	4		
ES 1Z		0.7	30	1.5	0.6	Axial(E1)	3	
ES01Z			30	1.5	0.6	Axial(E0)	2	
AU02Z		0.8	25	0.4	0.18	Axial(A0)	1	
EU02Z		1.0	15	0.4	0.18	Axial(E0)	2	
EU 2Z			15	0.4	0.18	Axial(E1)	3	
RU 2Z			20	0.4	0.18	Axial(R1)	4	
RU 4Z		3.5	70	0.4	0.18	Axial(R4)	7	
RU 30Z			80	0.4	0.18	Axial(R3)	6	
EU01		400	0.25	15	0.4	0.18	Axial(E0)	2
EU 1				15	0.4	0.18	Axial(E1)	3
RU 1				15	0.4	0.18	Axial(R1)	4
AU01		400	0.5	15	0.4	0.18	Axial(A0)	1
RF 1	0.6		15	0.4	0.18	Axial(R1)	4	
AS01			20	1.5	0.6	Axial(A0)	1	
EH 1			30	4.0	1.3	Axial(E1)	3	
RH 1	35		4.0	1.3	Axial(R1)	4		
ES01	0.7		30	1.5	0.6	Axial(E0)	2	
ES 1			30	1.5	0.6	Axial(E1)	3	
AU02	0.8		25	0.4	0.18	Axial(A0)	1	
EU02	1.0		15	0.4	0.18	Axial(E0)	2	
EU 2			15	0.4	0.18	Axial(E1)	3	
RU 2M	1.1		20	0.4	0.18	Axial(R1)	4	
RU 3	1.5		20	0.4	0.18	Axial(R2)	5	
RU 3M			50	0.4	0.18	Axial(R2)	5	
RU 30	2.0		200	0.4	0.18	Axial(R3)	6	
RU 4	3.0		50	0.4	0.18	Axial(R4)	7	
RU 31			150	0.4	0.18	Axial(R3)	6	
RU 4M	3.5		70	0.4	0.18	Axial(R4)	7	
EU01A	600		0.25	15	0.4	0.18	Axial(E0)	2
EU 1A				15	0.4	0.18	Axial(E1)	3
RU 1A		15		0.4	0.18	Axial(R1)	4	
AU01A		0.5	15	0.4	0.18	Axial(A0)	1	
RF 1A		0.6	15	0.4	0.18	Axial(R1)	4	
AS01A			20	1.5	0.6	Axial(A0)	1	
EH 1A			30	4.0	1.3	Axial(E1)	3	
RH 1A		35	4.0	1.3	Axial(R1)	4		
ES01A		0.7	30	1.5	0.6	Axial(E0)	2	
ES 1A			30	1.5	0.6	Axial(E1)	3	

Part No.	V _{RM} (V)	I _F (A)	I _{FSM} (A)	trr① (μS)	trr② (μS)	Package	Fig. No.		
RS 1A	600	0.7	30	1.5	0.6	Axial(R1)	4		
AU02A		0.8	25	0.4	0.18	Axial(A0)	1		
EU02A		1.0	15	0.4	0.18	Axial(E0)	2		
EU 2A			15	0.4	0.18	Axial(E1)	3		
RU 2		1.1	20	0.4	0.18	Axial(R1)	4		
RU 2AM			20	0.4	0.18				
RU 20A		1.5	20	0.4	0.18	Axial(R2)	5		
RU 3A			20	0.4	0.18				
RU 3AM			50	0.4	0.18				
RU 30A		2.0	200	0.4	0.18	Axial(R3)	6		
RU 4A		3.0	50	0.4	0.18	Axial(R4)	7		
RU 31A			150	0.4	0.18	Axial(R3)	6		
RU 4AM		3.5	70	0.4	0.18	Axial(R4)	7		
FMU-G16S		5.0	30	0.4	0.18	TO-220F2Pin	8		
FMU-G26S		10.0	40	0.4	0.18				
RU 1B		800	0.25	15	0.4	0.18	Axial(R1)	4	
RF 1B			0.6	15	0.4	0.18			
RH 1B				35	4.0	1.3			
RS 1B			0.7	30	1.5	0.6			
RU 2B	1.0		20	0.4	0.18				
RU 3B	1.1		20	0.4	0.18	Axial(R2)			5
RU 4B	3.0		50	0.4	0.18	Axial(R4)			7
RU 1C	1000	0.2	15	0.4	0.18	Axial(R1)	4		
RH 1C		0.6	35	4.0	1.3				
RU 2C		0.8	20	0.4	0.18				
RU 3C	1000	1.5	20	0.4	0.18	Axial(R2)	5		
RU 4C		2.5	50	0.4	0.18	Axial(R4)	7		
RH 2D	1300	1.0	60	4.0	1.3	Axial(R2)	5		
RU 4D		1.5	50	0.4	0.18	Axial(R4)	7		
RU 4DS		2.5	50	0.4	0.18	Axial(R4)			
ES01F	0.5	20	1.5	0.6	Axial(E0)	2			
ES 1F		20	1.5	0.6	Axial(E1)	3			
RH 10F	0.8	60	4.0	1.3	Axial(R1)	4			
RH 2F	1.0	60	4.0	1.3	Axial(R2)	5			
RP 3F		50	0.7	0.3	Axial(R3)	6			
RS 3FS	2.0	50	2.0	0.8	Axial(R3)				
RH 4FS		1500	50	1.0	0.4	Axial(R4)	7		
RH 3F	2.5		50	4.0	1.3	Axial(R3)	6		
RH 4F			50	4.0	1.3	Axial(R4)	7		
FMQ-G1FS	5.0	50	0.7	0.3	TO-220F-2Pin	8			
FMQ-G2FS		50	0.5	0.2	TO-220F-2Pin				
FMQ-G2FMS	10.0	50	0.5	0.25	TO-220F-2Pin	9			
FMQ-G5FMS		50	0.5	0.2	TO-3PF-2Pin				
FMU-G2FS		50	0.6	0.25	TO-220F-2Pin				
FMQ-G2FLS		50	1.2	0.4	TO-220F-2Pin				
RH 3G	1600	2.5	50	4.0	1.3	Axial(R3)	6		
FMQ-G5GS	1700	10.0	50	0.5	0.2	TO-3PF-2Pin	9		
FMP-G5HS	1800	8.0	50	1.0	0.4	TO-3PF-2Pin			
FMR-G5HS		10.0	50	1.8	0.7	TO-3PF2Pin			
RC 2	2000	0.2	20	4.0	1.3	Axial(R1)	4		

External Dimensions

• No. 1 Axial (A0)

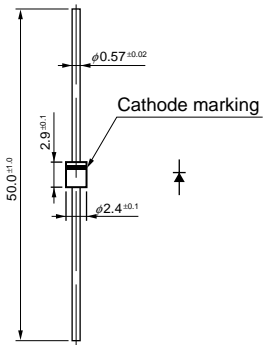

• No. 2 Axial (E0)

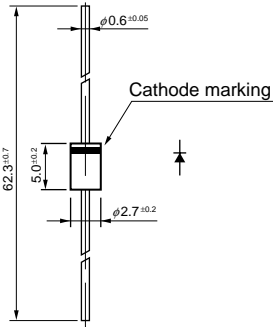

• No. 3 Axial (E1)

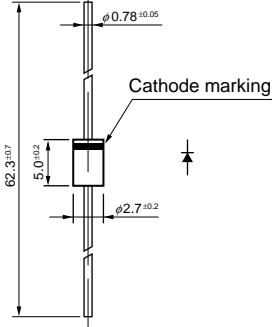

• No. 4 Axial (R1)

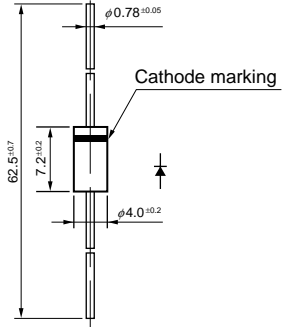

• No. 5 Axial (R2)

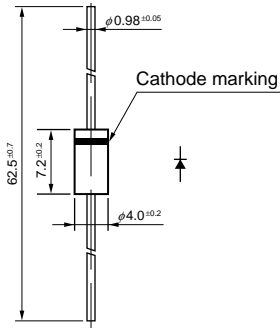

• No. 6 Axial (R3)

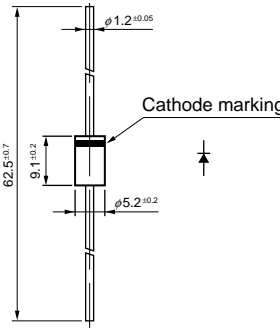

• No. 7 Axial (R4)

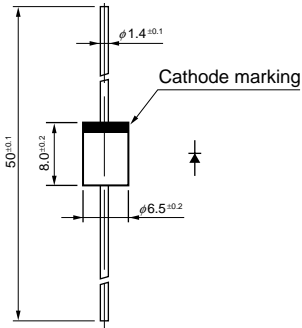

• No. 8 (TO-220F-2 Pin)

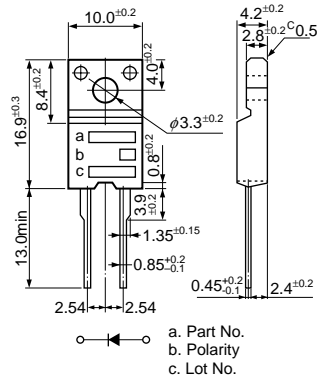

• No. 9 (TO-3PF-2 Pin)

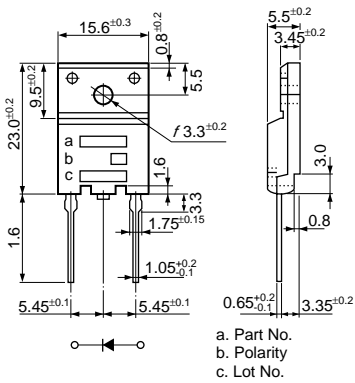

(unit: mm)

4-2-2 2 Chip

trr① : IR=IF 90% Recovery Point
 trr② : IR=2×IF 75% Recovery Point

Part No.	V _{RM} (V)	I _F (A)	I _{FSM} (A)	trr① (μS)	trr② (μS)	Package	Fig. No.
FMU-21S, R	100	10.0	40	0.4	0.18	TO-220F	1
FMU-12S, R	200	5.0	30	0.4	0.18	TO-220F	
FMU-22S, R		10.0	40	0.4	0.18	FM80	
FMU-32S, R		20.0	80	0.4	0.18		
FMU-14S, R	400	5.0	30	0.4	0.18	TO-220F	1
FMU-24S, R		10.0	40	0.4	0.18	FM80	
FMU-34S, R		20.0	80	0.4	0.18		
FMU-16S, R	600	5.0	30	0.4	0.18	TO-220F	1
FMUP-2506*		5.0	30	0.4	0.18		
FMU-26S, R		10.0	40	0.4	0.18	FM80	
FMU-36S, R		20.0	80	0.4	0.18		

* Under Development

External Dimensions

• No. 1 (TO-220F)

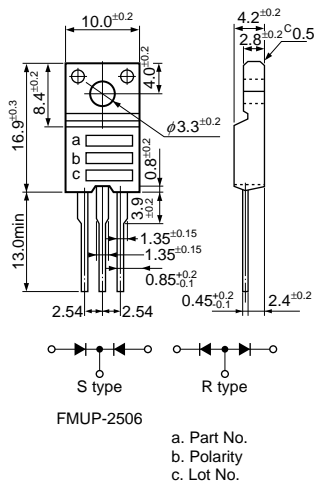

• No. 2 (FM80)

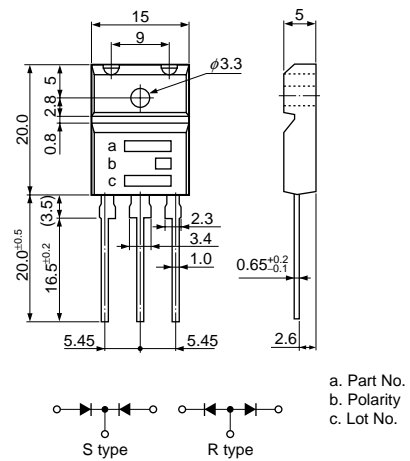

a. Part No.
 b. Polarity
 c. Lot No.

(unit: mm)

4-3-1 1 Chip

trr① : I_R=I_F

90% Recovery Point

trr② : I_R=2×I_F

75% Recovery Point

Part No.	V _{RM} (V)	I _F (A)	I _{FSM} (A)	trr① (nS)	trr② (nS)	Package	Fig. No.
AG01Y	70	1.0	25	100	50	Axial(A0)	3
EG01Y			30	100	50	Axial(E0)	4
EG 1Y		1.1	30	100	50	Axial(E1)	5
RG 10Y			50	100	50	Axial(R1)	6
RG 2Y		1.5	50	100	50	Axial(R2)	7
RG 4Y			3.5	100	100	50	Axial(R4)
AG01Z	200	0.7	15	100	50	Axial(A0)	3
EG01Z			15	100	50	Axial(E0)	4
EG 1Z		0.8	15	100	50	Axial(E1)	5
SFPL-52			0.9	25	50	35	Surface mount (SFP)
SFPL-62		1.0	25	50	35	Axial(A0)	
AL01Z			25	100	50	Axial(E0)	4
EN 01Z		1.2	50	100	50	Axial(R1)	6
RG 10Z			50	100	50	Axial(R2)	7
RG 2Z		1.5	20	50	35	Axial(E1)	5
EL 1Z			25	40	30	Axial(E0)	4
EL02Z		3.0	30	30	25	Surface mount (SFP)	1
SFPX-62			60	100	50		
RN 1Z		2.0	30	30	25	Axial(R2)	7
RX 10Z			30	50	35	Surface mount (D pack)	2
RL 10Z		3.0	50	30	25		
RL 2Z			80	100	50	Axial(R4)	9
RN 2Z		3.5	80	50	35	Axial(R3)	8
SPX-G32S			80	50	35	Axial(R4)	9
RX 3Z		5.0	80	50	35	Axial(R3)	8
RN 3Z			120	100	50	Axial(R4)	9
RG 4Z	10.0	80	50	35	Axial(R3)	8	
RL 3Z		80	50	35	Axial(R4)	9	
RL 4Z	5.0	80	50	35	Axial(R3)	8	
RN 4Z		100	100	50	Axial(R4)	9	
FMX-G12S	300	5.0	65	30	25	TO-220F-2Pin	10
FML-G12S			65	40	30		
FMP-G12S			65	150	70		
FMN-G12S			100	100	50		
MPL-102S		10.0	65	40	30	Surface mount (TO-220S)	12
FMX-G22S			150	30	25	TO-220F-2Pin	10
FML-G22S	400	2.0	30	30	25	Surface mount (SFP)	1
SFPX-63			5.0	70	50	35	TO-220F-2Pin
FML-G13S	400	0.7	15	100	50	Axial(A0)	3
AG01			0.8	15	100	50	Axial(E0)
EG01		15		100	50	Axial(E1)	5
EG 1		1.0	20	50	35	Axial(A0)	3
AL01*			25	50	30	Surface mount (SFP)	1
SFPL-64		1.2	50	100	50	Axial(R1)	6
RG 10			50	100	50	Axial(R2)	7
RG 2		1.5	25	50	35	Axial(E1)	5
EL 1			2.0	40	50	35	Axial(R2)
RL 2		3.0	70	50	35	Axial(R3)	8
RL31*			80	100	50	Axial(R4)	9
RG 4		3.5	80	50	35	Axial(R3)	8
RL 3	70		30	25	TO-220F-2Pin	10	
FMX-G14S*	5.0	70	50	35			
FML-G14S		70	100	50			
FMN-G14S							

Part No.	V _{RM} (V)	I _F (A)	I _{FSM} (A)	trr① (nS)	trr② (nS)	Package	Fig. No.	
EG01A	600	0.5	10	100	50	Axial(E0)	4	
AG01A			15	100	50	Axial(A0)	3	
EG 1A		0.6	10	100	50	Axial(E1)	5	
RG 10A			50	100	50	Axial(R1)	6	
RG 2A		1.0	50	100	50	Axial(R2)	7	
RD 2A			1.2	30	50			35
RG 4A		2.0	50	100	50	Axial(R4)	9	
RL 3A			60	50	35	Axial(R3)	8	
RL 4A		3.0	80	50	35	Axial(R4)	9	
FMG-G26S			4.0	50	100	50	TO-220F-2Pin	10
FMX-G16S		5.0	50	30	25			
FML-G16S			50	50	35			
FMN-G16S*	8.0	50	100	50	FM80-2Pin	11		
FMG-G36S		80	100	50				
FMX-G26S	10.0	100	30	25	TO-220F-2Pin	10		
FMD-G26S		100	50	30				
FML-G26S	30.0	100	65	35	Surface mount (TO-220S)	12		
MP3-306		180	150	70				
FMC-G28S	800	3.0	50	70	35	TO-220F-2Pin	10	
FMC-G28SL		5.0	60	70	35	TO-220F-2Pin		
AP01C	1000	0.2	5	200	80	Axial(A0)	3	
EP01C			5	200	80	Axial(E0)	4	
RU 1P		0.4	10	100	50	Axial(R1)	6	
EG01C			0.5	10	100	50	Axial(E0)	4
RG 1C		0.7	10	100	50	Axial(R1)	6	
RG 4C			2.0	60	100	50	Axial(R4)	9
FMG-G2CS		3.0	30	100	50	TO-220F-2Pin	10	
FMG-G3CS			5.0	60	150	70	FM80-2Pin	11
RP 1H		2000	0.1	5	200	80	Axial(R1)	6

* Under Development

External Dimensions

• No. 1 Surface Mount (SFP)

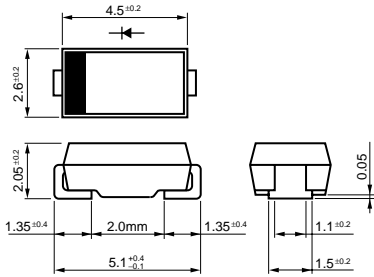

• No. 2 Surface Mount (D pack)

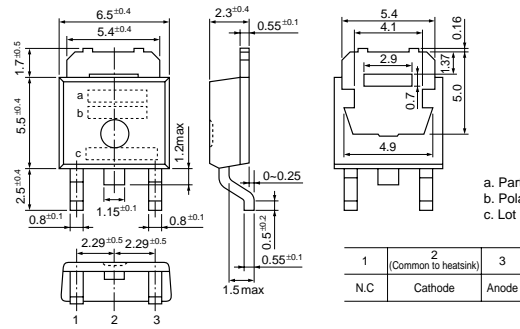

• No. 3 Axial (A0)

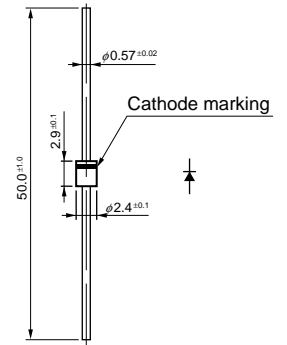

• No. 4 Axial (E0)

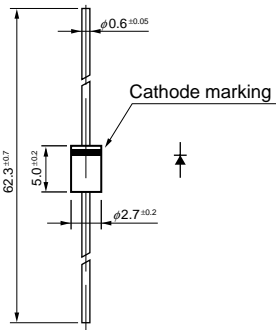

• No. 5 Axial (E1)

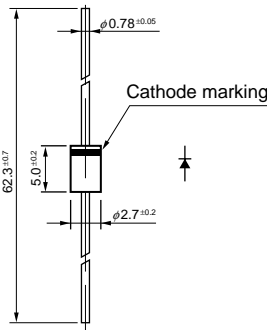

• No. 6 Axial (R1)

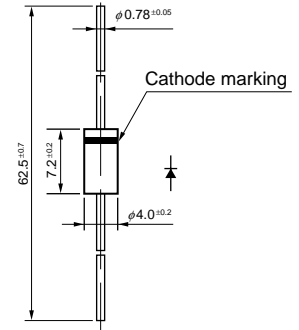

• No. 7 Axial (R2)

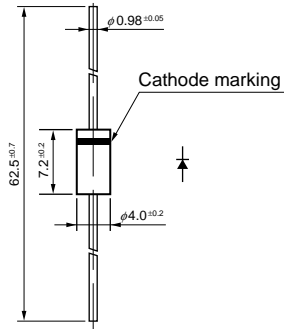

• No. 8 Axial (R3)

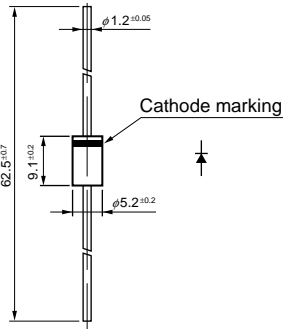

• No. 9 Axial (R4)

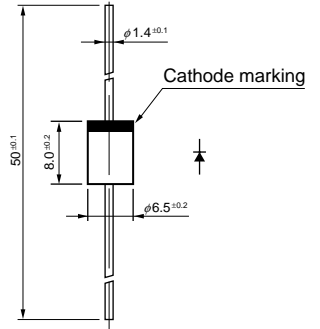

• No. 10 (TO-220F-2 Pin)

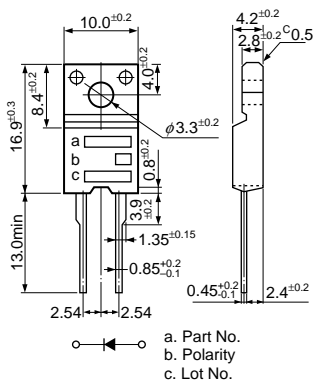

• No. 11 (FM80-2 Pin)

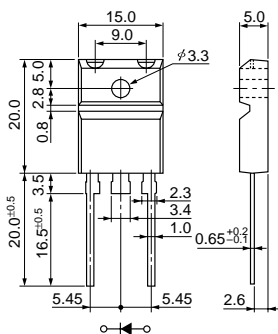

• No. 12 Surface Mount (TO-220S)

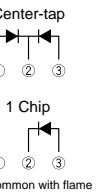
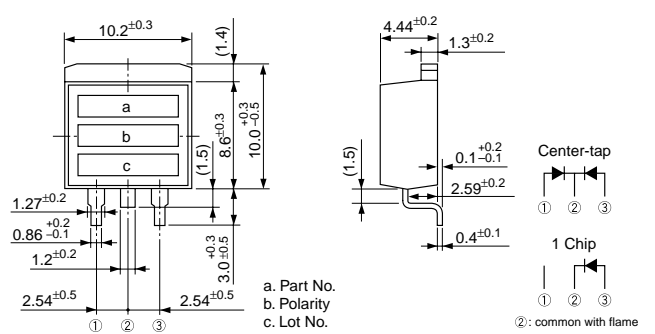

(unit: mm)

4-3-2 2 Chip

Part No.	V _{RM} (V)	I _F (A)	I _{FSM} (A)	trr① (nS)	trr② (nS)	Package	Fig. No.	
FMX-12S	200	5.0	35	30	25	TO-220F	2	
FML-12S			35	40	30			
FMG-12S, R			35	100	50			
SPX-62S		6.0	80	30	25	Surface mount (D pack)	1	
FMX-22S				65	30			25
FML-22S				65	40			30
FMG-22S, R		10.0	65	100	50	TO-220F	2	
FMX-22SL				100	30			25
FMX-32S				150	30			25
FML-32S		20.0	150	40	30	FM80	3	
MP2-202S				110	50			35
FMG-32S, R				150	100			50
FML-13S	300	5.0	40	50	35	TO-220F	2	
FMG-13S, R			35	100	50			
FMX-23S			65	30	25			
FMG-23S, R		10.0	65	100	50	TO-220F	2	
FML-23S				70	50			35
FMX-2203				100	30			25
FMX-33S		20.0	100	30	25	FM80	3	
FML-33S				100	50			35
FMG-33S, R				150	100			50

trr① : I_R=I_F 90% Recovery Point
trr② : I_R=2×I_F 75% Recovery Point

Part No.	V _{RM} (V)	I _F (A)	I _{FSM} (A)	trr① (nS)	trr② (nS)	Package	Fig. No.		
FMG-14S, R	400	5.0	35	100	50	TO-220F	2		
FML-14S			40	50	35				
FMG-24S, R			8.0	65	100			50	
FML-24S		10.0	70	50	35	FM80	3		
FMG-34S, R				16.0	100			100	50
FML-34S				20.0	100			50	35
FMC-26U	600	3.0	50	70	35	TO-220F	2		
FMG-26S, R			6.0	50	100			50	
FMG-36S, R			15.0	80	100			50	
FML-36S	800	20.0	100	65	35	FM80	3		
FMC-28U			1200	3.0	50			70	35
FMC-26UA			1600	3.0	50			70	35
FMC-28UA						TO-220F-2Pin	4		

External Dimensions

• No. 1 Surface Mount (D pack)

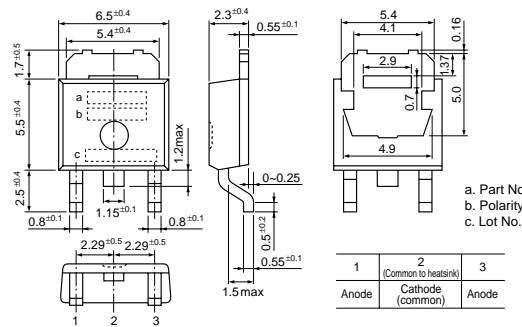

• No. 2 (TO-220F)

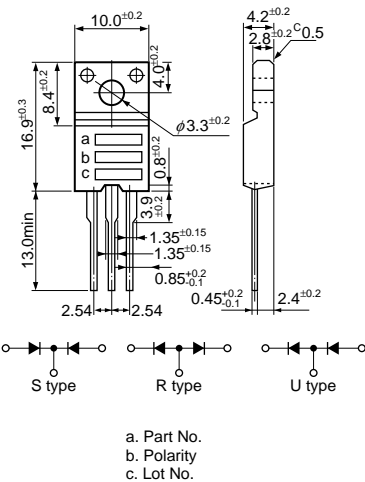

• No. 3 (FM80)

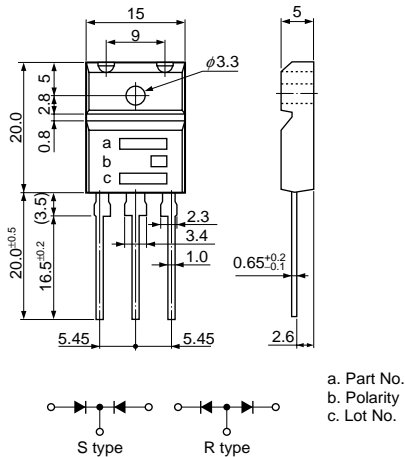

• No. 4 (TO-220F-2 Pin)

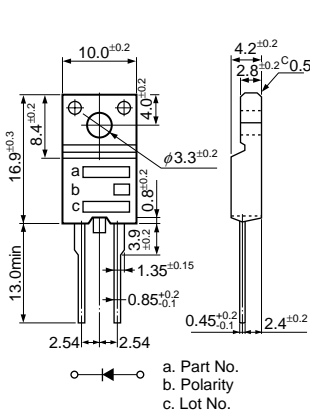

• No. 5 Surface Mount (TO-220S)

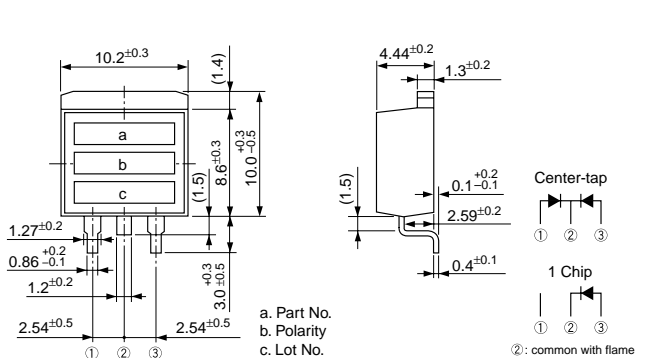

(unit: mm)

4-3-3 Bridge

trr① : $I_R=I_F$ 90% Recovery Point
 trr② : $I_R=2 \times I_F$ 75% Recovery Point

Part No.	V _{RM} (V)	I _F (A)	I _{FSM} (A)	trr① (nS)	trr② (nS)	Package	Fig. No.
RBV-402L	200	4.0	80	40	30	RBV-40	1
RBV-602L		6.0	100	50	35	RBV-60	2

External Dimensions

• No. 1 (RBV-40)

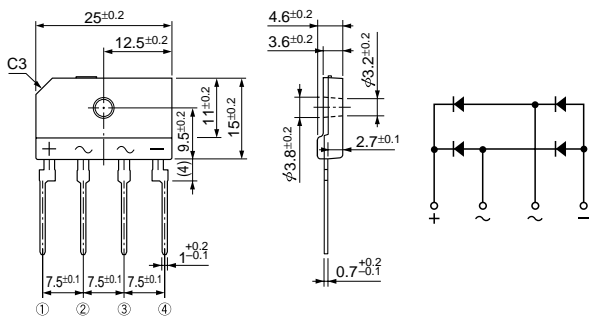

• No. 2 (RBV-60)

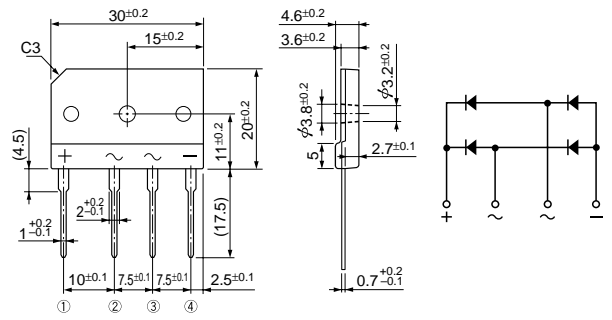

(unit: mm)

4-4-1 1 Chip

Part No.	V _{RM} (V)	I _O (A)	V _F (V)	I _R (mA)	Package	Fig. No.	
SFPA-53	30	1.0	0.36	1.5	Surface mount (SFP)	2	
EA 03			0.36	1.5	Axial(E0)	5	
MI2A3*			0.39	2.0	Surface mount (Compact)	1	
SFPJ-53			0.45	1.0	Surface mount (SFP)	2	
MI1A3			0.47	1.0	Surface mount (Compact)	1	
AK 03			0.55	1.0	Axial(A0)	4	
EK 03			0.55	5.0	Axial(E0)	5	
EK 13			1.5	0.55	5.0	Axial(E1)	6
RK 13			1.7	0.55	5.0	Axial(R1)	7
SFPA-63			2.0	0.36	3.0	Surface mount (SFP)	2
RA 13		0.36		3.0	Axial(R1)	7	
SFPJ-63		0.45		2.0	Surface mount (SFP)	2	
SFPE-63*		0.55		0.2			
RK 33		2.5		0.55	5.0	Axial(R2)	8
SFPA-73		3.0		0.36	4.5	Surface mount (SFP)	2
SFPJ-73				0.45	3.0		
RJ 43				0.45	3.0	Axial(R4)	9
RK 43				0.55	5.0		
SPJ-G53S		5.0		0.45	5.0	Surface mount (D pack)	3
SFPB-54		40	1.0	0.55	1.0	Surface mount (SFP)	2
AK 04				0.55	1.0	Axial(A0)	4
EK 04				0.55	5.0	Axial(E0)	5
AE 04*				0.6	0.1	Axial(A0)	4
AW 04				0.58	5.0	Axial(A0)	4
SFPB-64			1.5	0.55	5.0	Surface mount (SFP)	2
EK 14				0.55	5.0	Axial(E1)	6
RK 14			1.7	0.55	5.0	Axial(R1)	7
SFPB-74			2.0	0.50	5.0	Surface mount (SFP)	2
SFPE-64				0.60	0.2		
EE 04*			2.5	0.6	0.2	Axial(E0)	5
RK 34	0.55			5.0	Axial(R2)	8	
SPB-G34S	3.0		0.55	3.5	Surface mount (D pack)	3	
RK 44			0.55	5.0	Axial(R4)	9	
FMB-G14			0.60	5.0	TO-220F-2Pin	10	
SPB-G54S	5.0		0.55	5.0	Surface mount (D pack)	3	
FMB-G14L			0.55	5.0			
FMB-G24H	10		0.55	10	TO-220F-2Pin	10	

* Under Development

Part No.	V _{RM} (V)	I _O (A)	V _F (V)	I _R (mA)	Package	Fig. No.	
SFPB-56	60	0.7	0.62	1.0	Surface mount (SFP)	2	
AK 06			0.62	1.0	Axial(A0)	4	
EK 06			0.62	1.0	Axial(E0)	5	
SFPW-56		1.5	0.7	1.0	Surface mount (SFP)	2	
EK 16			0.62	1.0	Axial(E1)	6	
RK 16			0.62	1.0	Axial(R1)	7	
SFPB-76		2.0	0.62	2.0	Surface mount (SFP)	2	
RK 36			0.62	2.0	Axial(R2)	8	
SFPB-66			0.69	1.0	Surface mount (SFP)	2	
RK 46			3.5	0.62	3.0	Axial(R4)	9
FMB-G16L		5.0	0.62	5.0	TO-220F-2Pin	10	
SPB-G56S		6.0	0.70		Surface mount (D pack)	3	
SFPB-59		90	0.7	0.81	1.0	Surface mount (SFP)	2
AK 09				0.81	1.0	Axial(A0)	4
EK 09				0.81	1.0	Axial(E0)	5
SFPB-69			1.5	0.81	2.0	Surface mount (SFP)	2
EK 19				0.81	2.0	Axial(E1)	6
RK 19				0.81	2.0	Axial(R1)	7
RK 39				2.0	0.81	3.0	Axial(R2)
RK 49			3.5	0.81	5.0	Axial(R4)	9
FMB-G19L	4.0		0.81	5.0	TO-220F-2Pin	10	

External Dimensions

• No. 1 Surface Mount (SOT23)

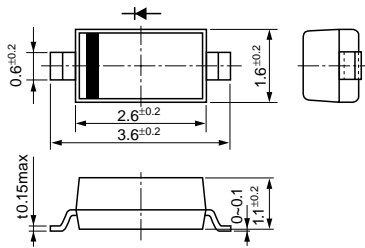

• No. 2 Surface Mount (SFP)

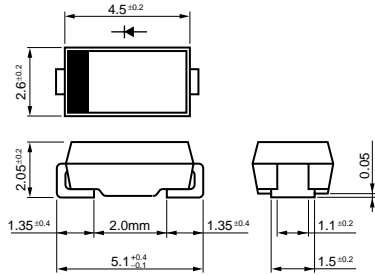

• No. 3 Surface Mount (D pack)

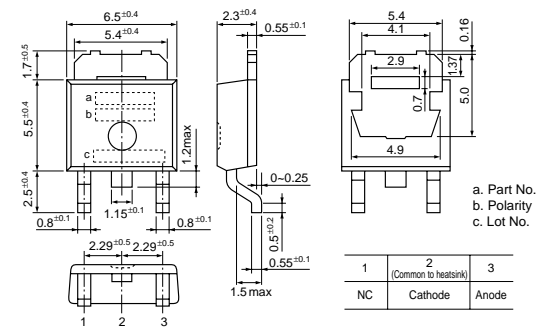

• No. 4 Axial (A0)

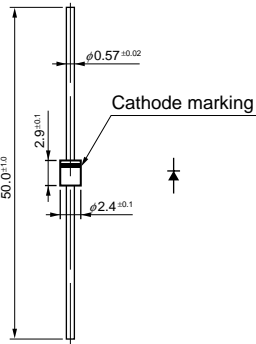

• No. 5 Axial (E0)

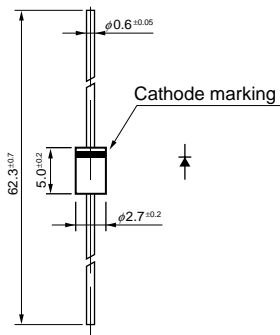

• No. 6 Axial (E1)

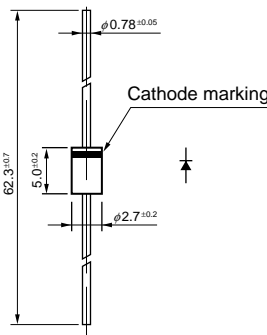

• No. 7 Axial (R1)

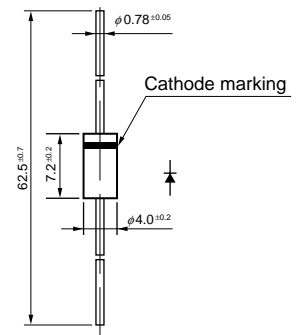

• No. 8 Axial (R2)

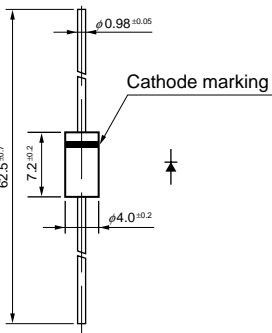

• No. 9 Axial (R4)

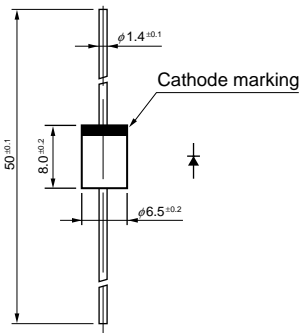

• No. 10 (TO-220F-2 Pin)

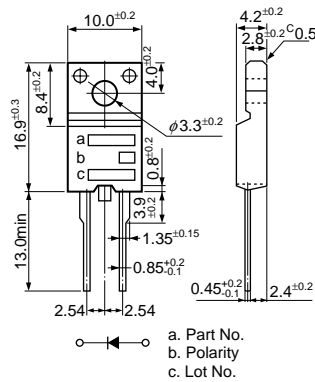

(unit: mm)

4-4-2 2 Chip

Part No.	V _{RM} (V)	I _o (A)	V _F (V)	I _R (mA)	Package	Fig. No.
SPJ-63S	30	6.0	0.45	3.0	Surface mount (D pack)	1
FMJ-23L		10	0.45	5.0	TO-220F	2
FMJ-2203		20	0.45	10		
FMJ-2303		30	0.45	15		
FMB-24	6.0	4.0	0.55	5.0	TO-220F	1
SPB-64S		0.55	3.5	Surface mount (D pack)		
FMB-24M	10	0.55	5.0	TO-220F	2	
FMW-24L		0.55	5.0	TO-220F		
FMB-24L		0.55	5.0			
FME-2104		0.60	0.5			
FMB-34S	40	12	0.58	5.0	FM80	4
FMW-24H		0.55	7.5	TO-220F	2	
FMB-24H			7.5	FM80	4	
FMB-34		15	0.55		10	TO-220S
MPE-24H			0.60	0.75		
FME-24H		20	0.60	0.75	TO-220F	2
FMB-2204			0.55	10	TO-220F	
FMW-2204			0.55	10		
FMB-2304	0.55		15			
FMB-34M	30	0.55	20	FM80	4	

Part No.	V _{RM} (V)	I _o (A)	V _F (V)	I _R (mA)	Package	Fig. No.	
FMB-26	60	4.0	0.62	1.0	TO-220F	2	
SPB-66S		6.0	0.65	1.0	Surface mount (D pack)	1	
FMB-26L		10	0.62	2.5	TO-220F	2	
FME-2106			0.72	1.0			
FMB-36		15	0.62	5.0	FM80	4	
FMB-2206		20	0.7	8.0	TO-220F	2	
FMB-36M	0.62		10.0				
FMB-2306	30	0.7	8.0	TO-220F	2		
FMB-29		4.0	0.81			3.0	
FMB-29L	90	8.0	0.81	5.0	TO-220F	4	
FMB-39		15	0.81	10			
FMB-39M		20	0.81	15			FM80
MPE-29G			0.85	1.0			
FME-220A	100	20	0.85	1.0	TO-220F	2	
FME-230A		30	0.85	1.5	TO-220F		

External Dimensions

• No. 1 Surface Mount (D pack)

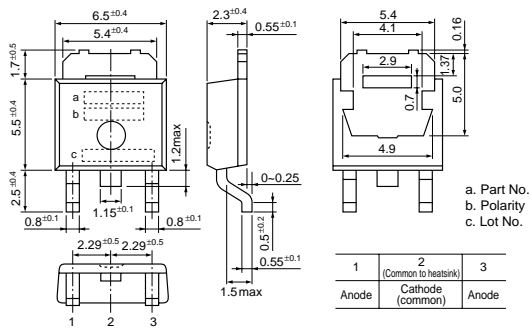

• No. 2 (TO-220F)

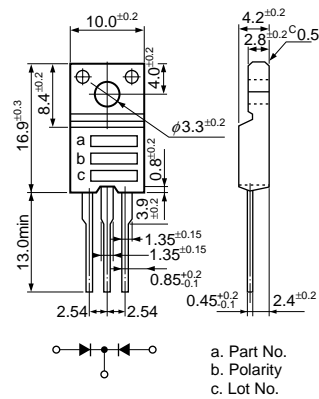

• No. 3 (TO-220S)

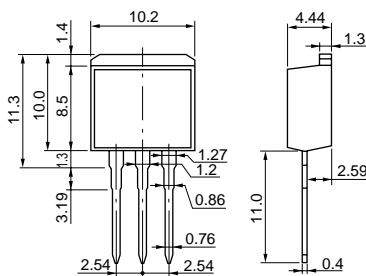

• No. 4 (FM80)

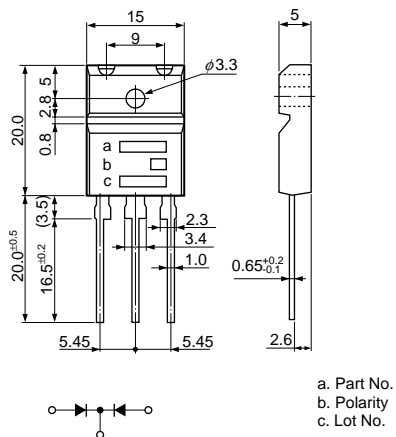

(unit: mm)

4-4-3 Bridge

Part No.	V_{RM} (V)	I_o (A)	V_F (V)	I_R (mA)	Package	Fig. No.
RBV-406B	60	4.0	0.62	2.0	RBV-40	1

External Dimensions

• No. 1 (RBV-40)

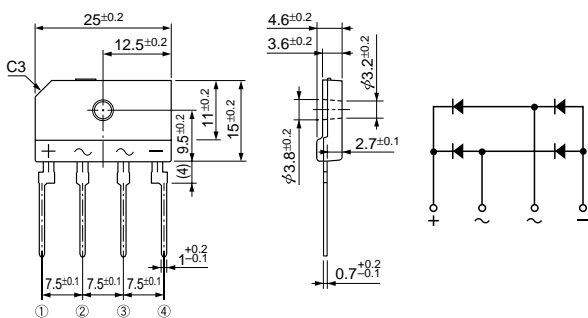

(unit: mm)

Division	Part No.	V _{RM} (kV)	I _{F(AV)} (mA)	V _{F (max)} (V)	trr (μS) I _F =I _{RP}		Fig. No.
					Ta=25°C	Ta=100°C	
General purpose	SHV-02	2	2	16	0.18	-	1
	SHV-03S	3	2	16	0.18	-	
	SHV-03	3	2	16	0.18	-	2
For general FBT	SHV-10	10	2'	40	0.18	-	3
	SHV-12	12	2'	45	0.18	-	
	SHV-14	14	2'	55	0.18	-	
	SHV-16	16	2'	60	0.18	-	4
	SHV-20	20	2'	75	0.18	-	
	SHV-24	24	2'	75	0.18	-	
For high-frequency multi-layer FBT	SHV-06EN	6	2'	26	0.15	0.2	5
	SHV-08EN	8	2'	30	0.15	0.2	
	SHV-10EN	10	2'	38	0.15	0.2	6
	SHV-12EN	12	2'	45	0.15	0.2	
For ultra-high-frequency multi-layer FBT	SHV-08DN	8	2'	30	0.15	0.2	5
	SHV-10DN	10	2'	38	0.15	0.2	6
	SHV-12DN	12	2'	45	0.15	0.2	
For general type microwave oven	HVR-1X-40B	9	350	9	-	-	7
For inverter-type microwave oven	UX-F5B	8	350	14	0.15	-	
For automotive ignition coil	SHV-05JS	2.5	30	5	Vz=2.6~5.0kV		2
	SHV-06JN	3	30	6	Vz=3.2~6.0kV		5
	SHV-08J	4	30	8	Vz=4.5~8.0kV		8
	SHV-30J	15	30	30	Vz=16.0~30.0kV		6

*FBT High voltage Rectifier Capacitive Load, Tc≤100°C

External Dimensions

• No. 1

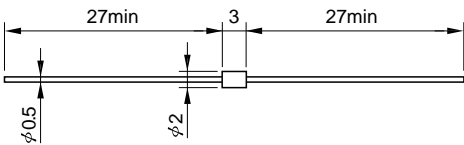

• No. 2

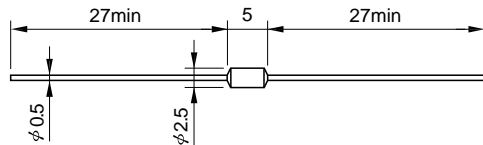

• No. 3

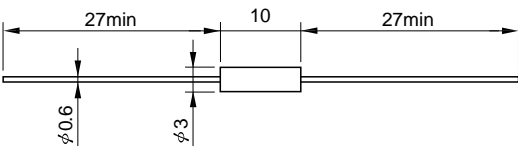

• No. 4

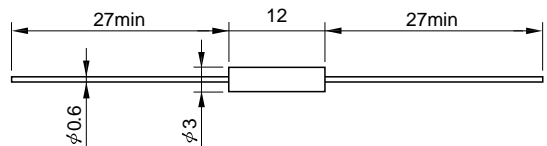

• No. 5

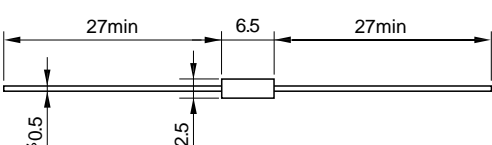

• No. 6

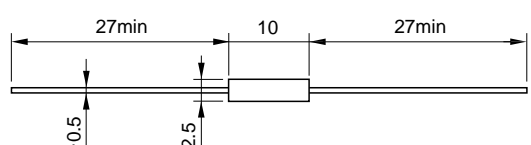

• No. 7

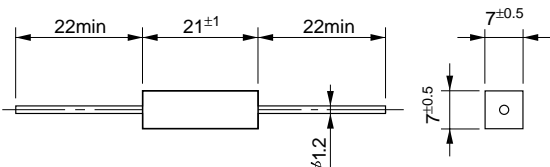

• No. 8

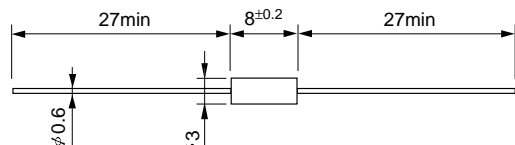

(unit: mm)

Part No.	V _Z (V)	V _{RDC} (V)	I _{TSM} (A)	Package	Fig. No.
RZ1030	27~ 33	20	30	Axial(R1)	1
RZ1040	34~ 40	28	30		
RZ1055	50~ 60	40	30		
RZ1065	60~ 70	50	30		
RZ1100	90~ 110	80	30		
RZ1125	115~ 135	105	30		
RZ1150	140~ 160	125	30	Axial(E0)	2
EZ0150					
RZ1155	150~ 165	138.7	30	Axial(R1)	1
RZ1175	165~ 185	150	30		
RZ1200	185~ 215	180	30		
RZ1235	220~250	179.5	30		
RZ1250	235~265	190	30		

External Dimensions

• No. 1 Axial (R1)

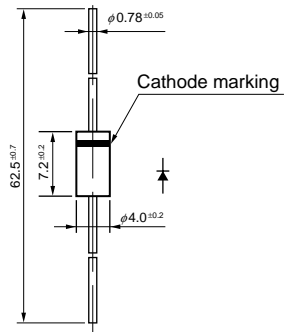

• No. 2 Axial (E0)

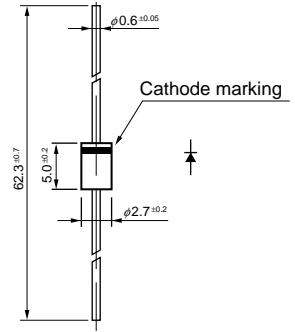

(unit: mm)

Part No.	V _Z (V)	P _R (W)	V _{DC} (V)	I _{TSM} (A)	Package	Fig. No.
PZ628	28±3.0	1500	20	65.0	Axial	1
SFPZ-68	28±3.0	50	20	2.0	Surface mount (SFP)	2
SPZ-G36	36±3.6	450	30	11.0	Surface mount (D pack)	3

External Dimensions

• No. 1 Axial (PZ628)

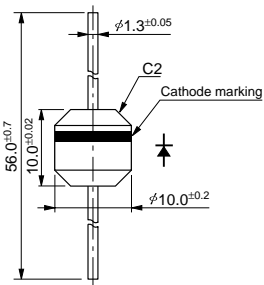

• No. 2 Surface Mount (SFP)

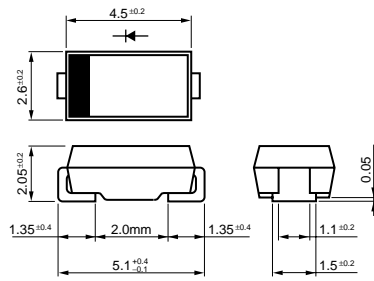

• No. 3 Surface Mount (D pack)

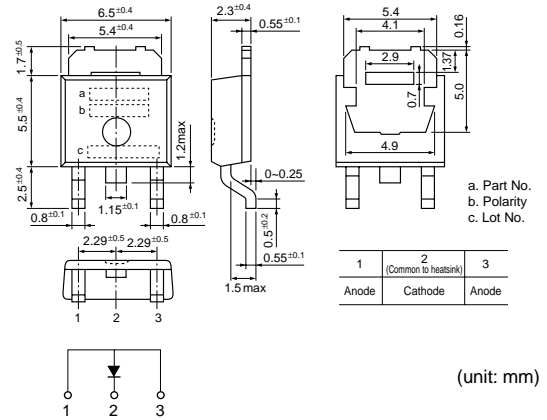

Division	Part No.	V _F (V)	I _F (mA)	I _{FSM} (A)	Package	Fig. No.
Unsymmetrical type	VR-60SS	1.5max	400	15	Axial(E0)	1
	VR-61SS	2.3±0.25	150	7.5		
	SV-2SS	4max	150	-		
	SV-3SS	2max	250	-		
	SV-4SS	1.8±0.2	150	-		
Symmetrical type	SV 02YS	1.2±0.2	200	30	Axial(E0)	2
	SV 03YS	1.8±0.2	150	16		
	SV 04YS	2.35±0.25	100	12		
	SV 05YS	3.0±0.3	80	10		
	SV 06YS	3.5±0.35	70	8		

External Dimensions

• No. 1 Axial (E0)

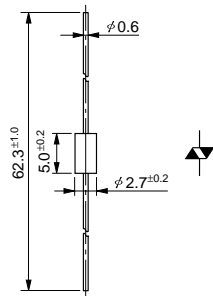

• No. 2 Axial (E0)

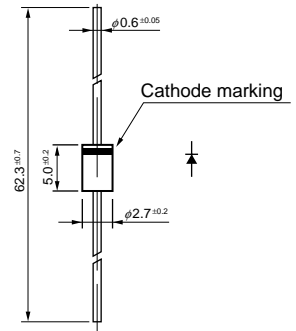

(unit: mm)

